

Winscombe Community Centre - The Latest Plans

Over the past few years a lot of work has gone into planning our new Community Centre and we've had to overcome pandemics and a huge rise in costs. However, we now have a clear strategy targeting summer of 2024 to start building.

The Plan

Since the spring of this year we have been working hard, preparing business plans and grant applications as well as refining the plans for the new building which are now fully costed. We have needed to be pragmatic about how we approach the project, due to the rise in costs and we are now planning a phased approach. The first phase will be a new two storey building, and the second will be refurbishment of the existing school building.

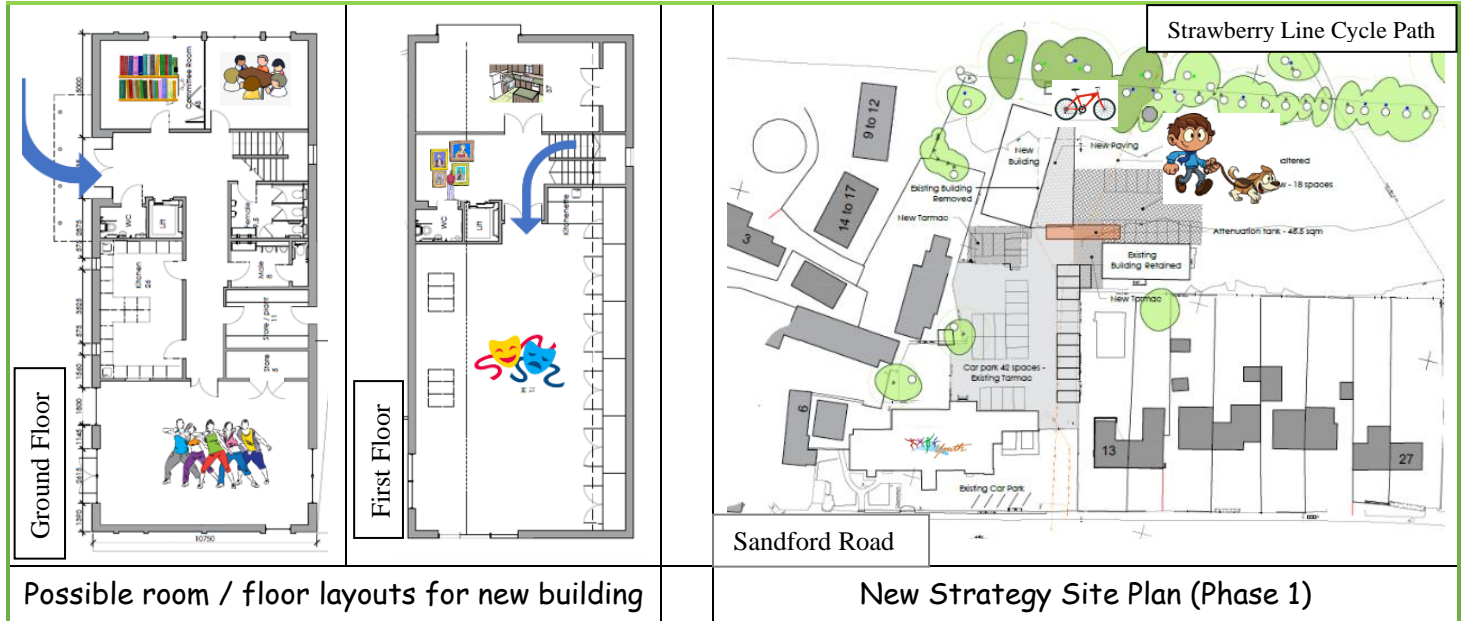

Phase 1 will see a new 2 storey building, drainage and parking completed within our set limit of £2M. We have revised our plans to ensure this is a realistic all-in budget. Phase 2 will then see the refurbishment of the Old School, with a focus on Youth and the Arts. Additional grants will be sought for this.



We have already identified £1.3M of the £2M build cost and are applying for a further £0.4M in grants. We will need an additional £0.3M from businesses and individual donations to make us achieve our goal.

We hope and believe our plans will provide what the Parish have been looking forward to for so long, to give:

- A medium sized function space (150m²) and an office space (s) (37m²) on the 1st Floor with stairs & lift access.
- Two hall spaces (70m² & 45m²) plus a fully equipped catering kitchen (26m²) on the ground floor.
- A large patio area and maybe a foyer at the front of the building connected to the field and Millennium Green.
- Continued use of the Old School, focusing on Youth and the Arts and full refurbishment to follow under Phase 2.
- Future proofed strategy with planning permission for an additional large auditorium style hall remaining in place for future Parish needs.

Next Steps - Starting very soon

More details in our next Newsletters

The setting up of different focus groups to look at the provisions needed for Users from nought to ninety, two leg, four or wheels

The launch of our fund raising campaign, to hit our building budget by starting an individual donation appeal.